

Tip II
Type II

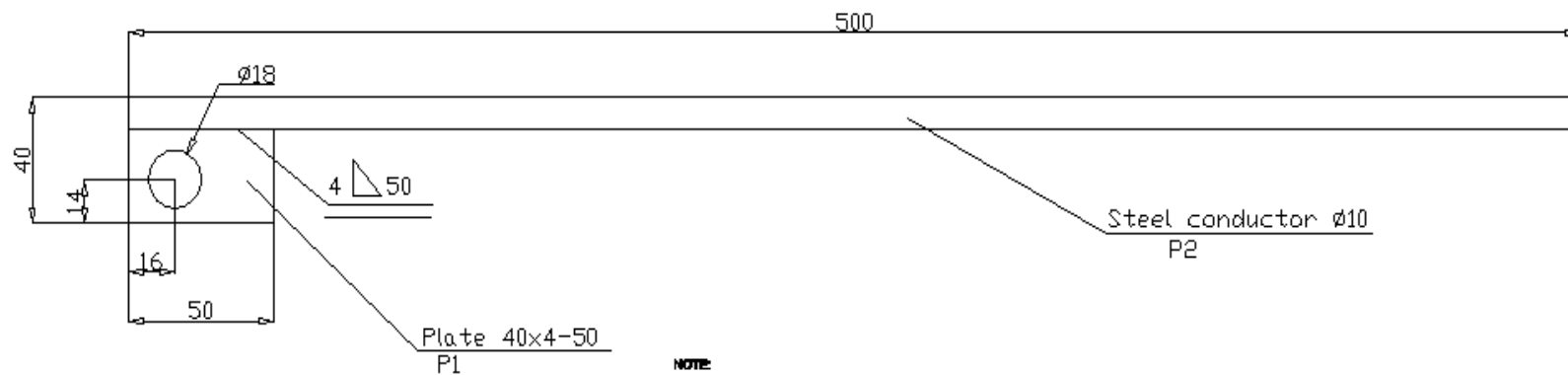

Tip I
Type I

NOTE:
 Profiles and plates will be made by general use steel, grade S235JR, according to EN 10224
 Coatings against corrosion will be applied after drilling and welding, by hot dip galvanizing.
 The coating minimum thickness will be:
 a) local coating 70 µm
 b) mean coating 80 µm

2	Placa 40x4-50 Plate 40x4-50		1 pcs.
1	Conductor de oel /10 mm Steel conductor /10 mm		500 mm.
REF / ITEM	DESCRIEREA REFERINTA / ITEM DESIGNATION	REFERINTA DWG / DWG REFERENCE	CANTITATE / QUANTITY

LISTA DE COMPONENTA / ITEM LIST

Se interzice copierea, difuzarea, reprodusarea sau utilizarea in alt scop, fara permisiunea proprietarului intelectual.
 Property of issuing entity, cannot be distributed or reproduced without authorization.



Drawing Title: Legatura de protectie - vedere axonometrica
 Denumire Descriere: Protection connection - axonometric view

Faza de proiectare / design phase	Numarul fiierului / CAD file name:	Scara / Scale:	Lvl	Spec.	Obiect	Type doc.	No.	Part	Rev.	Statut
DDE	03EAD00DE164		03	EA	00	DDE	164	3/3	A	.